

MODEL A COUPE

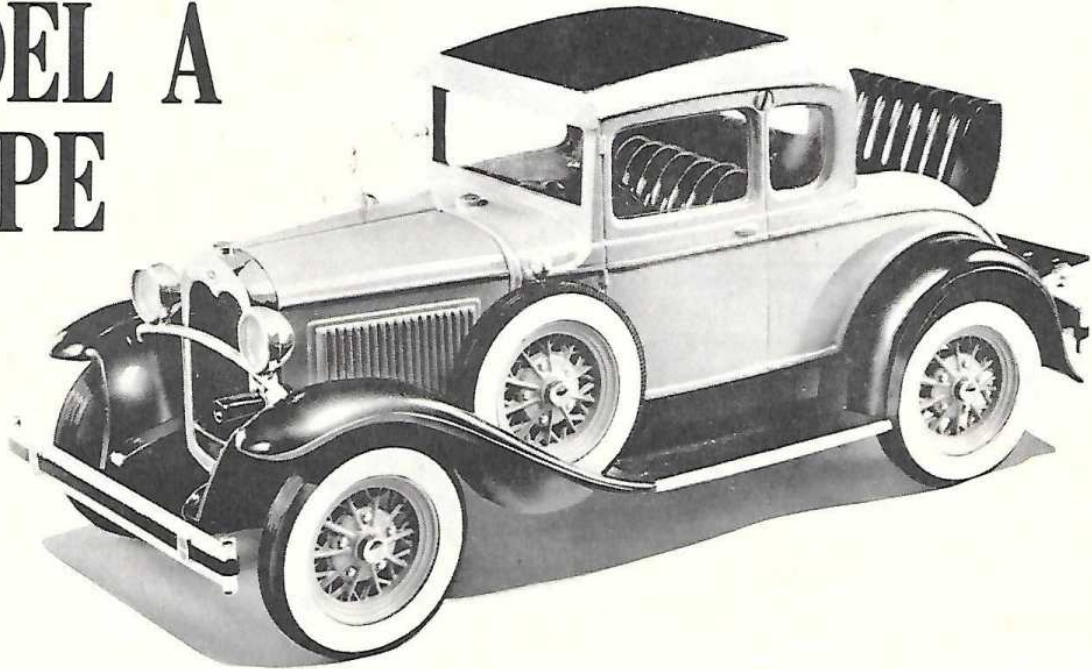

Mr. Ford formed the Ford Motor Company in June, 1903, after two previously unsuccessful ventures. The first Ford car to become famous was the Model T and its unprecedented popularity maintained the plant's production from 1908 until 1927. It was near the end of this period that Henry Ford felt the effect of his younger competitors who were forcing the venerable Model T to bow out after a long and glorious career.

Ford set his engineers to designing a car that would offer the American public an improved, reliable, low cost car. In May, 1927 the Model A was out of the planning stage and ready for the production line. On October 20, 1927 the first engine came down the line, and shortly thereafter, the Model A was presented to the public. The planetary transmission was replaced by a standard three-speed shift, the flywheel magneto gave way to the coil and battery ignition, and there were instruments on the instrument panel and lights to illuminate them. There was a foot-operated accelerator instead of the old hand throttle, and for the first time, safety glass was installed in the windshield. Other innovations were shock absorbers, four-wheel mechanical brakes, wire wheels, and a choice of colors.

About the Model A, Henry Ford said, "more than a car for the requirements of today." What Mr. Ford didn't know at the time was that the Model A really was the car of the future. In the period from October, 1927 to March, 1932, there were 4,848,340 Model A's constructed and sold. In the first month of production, 137 cars rolled off the assembly line, and by the end of December, 1927, 5,000 had been built.

In 1930, numerous changes were incorporated in the Model A. The engine lubrication system was improved, the emergency brake was relocated to the right of the gearshift lever, the radiator cooling surface was reduced, the road clearance was increased from 9 to 9½ inches, and the tire size was changed from 4.75 x 19 to 4.50 x 21.

The 1930 Model A Coupe had the handsome lines characteristic of the Town Sedan, but was patterned after the sporty configuration of the roadster. The coupe could be purchased in Andalusite Blue, Kewanee Green, Thorne Brown, Black, Chiclé, or Copra Drab, and the interior was outfitted with soft brown checked cloth. The Deluxe coupe boasted a more select interior with two colors of mohair or single colored Bedford cord upholstery, green toupe, and scroll-design hardware. The doors, windows, and cowl lights were appointed with mahogany garnished moldings.

The Model A has proven nearly indestructible and appears today in the guise of an "antique" car. A testimony to the popularity of the Model A is the existence of hundreds of Model A Clubs all over the country. Of the original 4,849,340 Model A Fords produced, there are 80,000 registered for use in Pennsylvania alone. An estimated 929,000 currently are registered throughout the United States.

IMPORTANT! —BEFORE BEGINNING ASSEMBLY, READ AND UNDERSTAND YOUR INSTRUCTIONS. Use pliers to break ejection pins from castings. Clean flash from castings with file contained in kit or pen knife. Using screws provided, pre-tap all screw holes. This is done by turning the proper sized screws into the screw holes and then removing them again. (Screws will drive more easily if they are first rubbed on a bar of soap.)

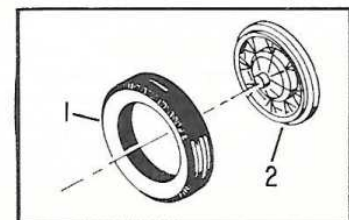
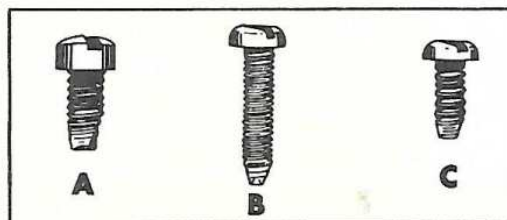
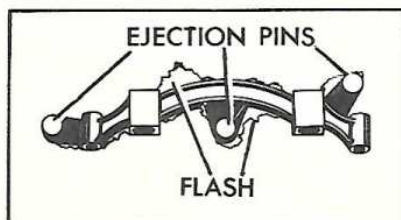

READ AND UNDERSTAND YOUR INSTRUCTIONS.

1. Slide tire (1) on to wheel (2).

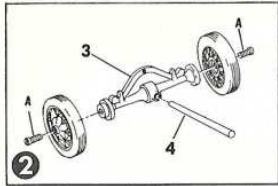

2. Attach two wheels to rear end assembly (3) using screws (A); make certain that lug nuts on wheels face outward. Insert drive shaft (4) into rear end assembly.

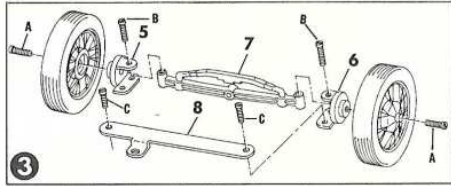

3. Attach wheel drums (5) (6) to front axle and spring assembly (7) using screws (B); position so that boss on axle faces forward. Assemble tie rod (8) to wheel drums using screws (C). Fasten two wheels to front wheel drums with screws (A).

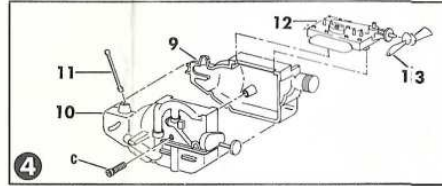

4. Press left and right halves of engine block (9) (10) together, inserting gear shift lever (11) in hole on top of transmission. Insert engine head (12) in slot on top of engine block and secure entire engine with screw (C). Attach fan (13).

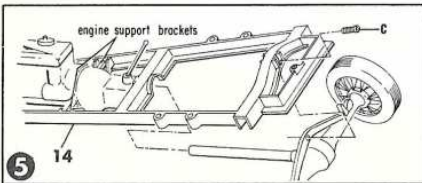

5. Rest engine on engine support brackets on frame (14). Insert drive shaft into rear of transmission and slide spring of rear end assembly into spring housing at rear of frame. Secure spring to frame with screw (C).

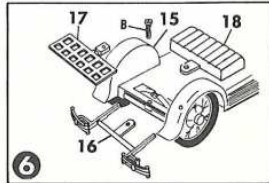

6. Drop chassis (15) into position on top of frame (14). Insert rear bumper (16) in slots provided. Position luggage rack (17) over bumpers. Position rumble seat (18) so that lugs fit into holes under seat. Use screw (B) to secure rumble seat, luggage rack, chassis and rear bumpers to frame. Insert front end assembly into front spring housing with tie rod toward rear of car. Position radiator (19) in front of front spring housing. Attach radiator and front end assembly to frame with screw (C). Attach hose (20) to radiator and engine.

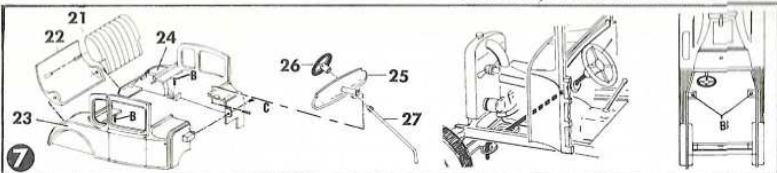
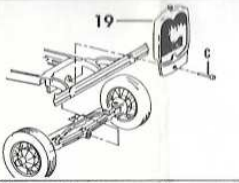

7. Press rumble seat back (21) onto rumble seat lid (22). Place rumble seat back assembly over post in rear right half of body (23). Position left half of body (24) using two posts provided and secure entire assembly with screw (C) through spark coil on firewall. Attach dashboard (25) to body with screw (C) through firewall. Press steering wheel (26) onto steering column (27) through dashboard and tie rod. Attach body to frame with two screws (B) through interior body mounts.

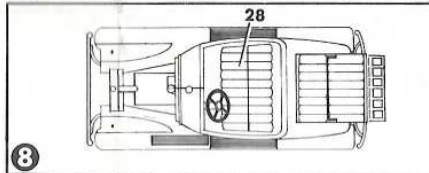

8. Drop front seat (28) into interior and fasten from underside of car with screw (C).

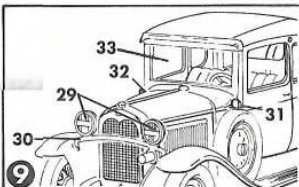

9. Press lenses (29) into headlight assembly (30). Press headlight assembly into holes in front fenders. Insert parking lights (31) (32) into upper cowl. Snap plastic windows (33) from sheet. Slide windows and windshield into position.

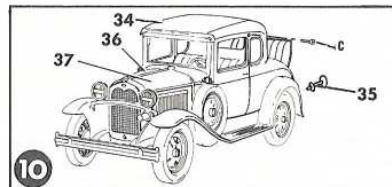

10. Position top of coupe (34) and secure with screws (C) in center of door post. Insert tail lights (35) into holes behind rear fenders. Press spare wheel into well in left front fender. Press two halves of hood (36) (37) together and install in position over engine.

If any parts should be missing, circle missing parts on parts list, cut out coupon, print name and address on other side, and mail to:

THE HUBLEY MANUFACTURING COMPANY
SCALE MODEL DIVISION
P. O. BOX 1543, LANCASTER, PA.
861K Parts List

- | | | |
|--------------------------|--------------------------|--------------------------------------|
| 1. RUBBER TIRES (5) | 14. FRAME | 28. FRONT SEAT |
| 2. WHEELS (5) | 15. CHASSIS | 29. HEADLIGHT LENSES |
| 3. REAR END DIFFERENTIAL | 16. REAR BUMPER | 30. HEADLIGHTS & CROSSBAR |
| 4. DRIVE SHAFT | 17. LUGGAGE RACK | 31. LEFT PARKING LIGHT |
| 5. RIGHT WHEEL DRUM | 18. RUMBLE SEAT | 32. RIGHT PARKING LIGHT |
| 6. LEFT WHEEL DRUM | 19. RADIATOR | 33. PLASTIC WINDSHIELD |
| 7. FRONT AXLE & SPRINGS | 20. RUBBER RADIATOR HOSE | 34. TOP |
| 8. TIE ROD | 21. RUMBLE SEAT BACK | 35. TAIL LIGHTS (2) |
| 9. LEFT ENGINE BLOCK | 22. RUMBLE SEAT LID | 36. ENGINE HOOD—RIGHT SIDE |
| 10. RIGHT ENGINE BLOCK | 23. BODY—RIGHT HALF | 37. ENGINE HOOD—LEFT SIDE |
| 11. GEAR SHIFT | 24. BODY—LEFT HALF | 38. PACKET OF SCREWS, REQUIRED SIZES |
| 12. ENGINE HEAD | 25. DASHBOARD | 39. WHITE SIDEWALL LABELS |
| 13. FAN | 26. STEERING WHEEL | 40. FILE |
| | 27. STEEL STEERING ROD | |

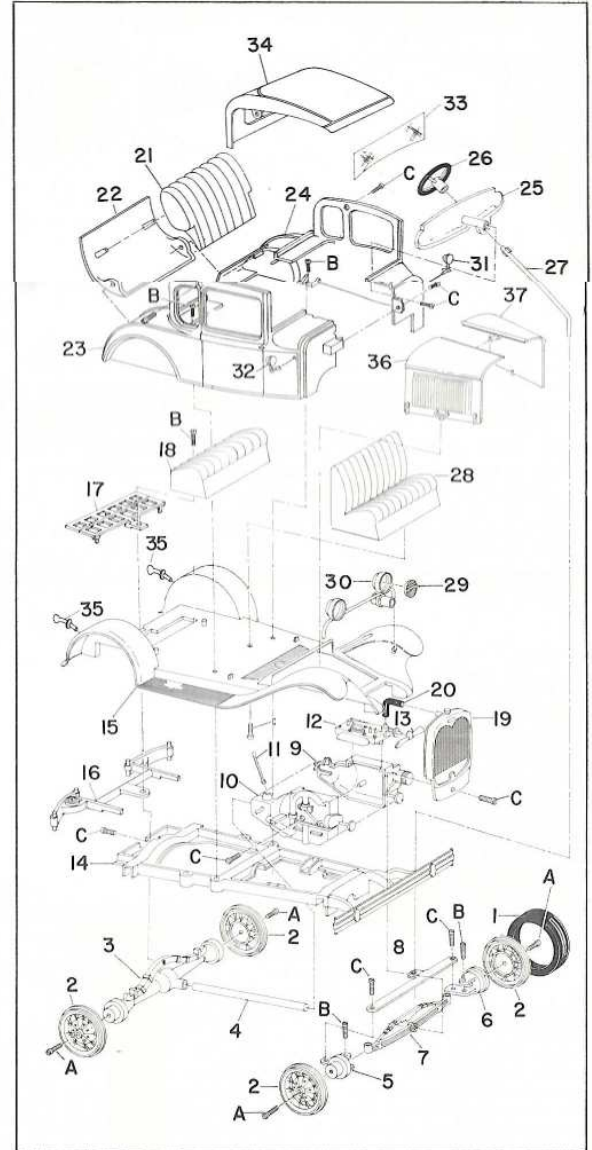

MODEL A kits by



In order to achieve an outstanding and authentic finish on your Hubley Metal Kit, the following steps are suggested:

1. All parts should be thoroughly cleaned and any loose metal dust removed.
2. Rub lightly with fine steel wool or Flex-i-grit reuseable sandpaper, (available at your Hobby store), until smooth.
3. Apply two or three coats of lacquer or enamel in the color desired, rubbing lightly between coats with fine steel wool. Enamel is recommended for hand brushing, but both lacquer and enamel are available in pressure spray cans at your hobby dealer. Wood part of body should be light tan.
4. **CAUTION**—Do not paint plastic parts with lacquer. This will cause wrinkling or crazing of the smooth surface.
5. To achieve a shiny finish on the chrome parts, any of the following methods may be used:
 - a. Buff parts with buffing wheel and then nickel or chrome plate.
 - b. Paint with aluminum enamel.
 - c. Polish with jewelers' rouge, buff, and then apply a coat of clear lacquer.

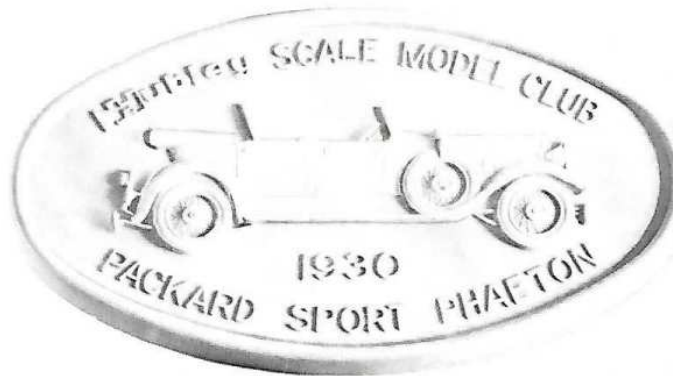

JOIN THE HUBLEY SCALE MODEL CLUB

Here's the deal! You will receive a 3 $\frac{3}{4}$ " chrome-plated, die-cast metal medallion (See photo above) for use as a wall plaque, paper weight, or bike plate. Also, you will receive a membership certificate, suitable for framing, and a set of multi-colored customizing decals. The Hubley Scale Model Club Newsletter, containing customizing tips for both plastic and metal kits, plus information, news and photos from other members, will be mailed to you as published. Send 50c (in coin) and end panel showing Stock No. from any Hubley Metal Kit box to JACK TEMPLE, c/o THE HUBLEY SCALE MODEL CLUB, BOX 1543, LANCASTER, PENNSYLVANIA.

Send 50c (in coin) and end panel showing
Stock No. from any Hubley Metal Kit box to
JACK TEMPLE
c/o THE HUBLEY SCALE MODEL CLUB
BOX 1543, LANCASTER, PENNA.

If you wish to become a member check here

(Print Plainly)

NAME _____ AGE _____

ADDRESS _____

CITY & STATE _____

INSPECTED BY

JBEC